









Options available

This industrial air curtain has very powerful air and heating outputs, making it suitable for use on warehouse and despatch area entrances up to 8 metres high.

The adjustable aerofoil shaped outlet vanes can be angled to provide the optimum seal across an entrance. It incorporates low noise centrifugal double inlet fans driven by an external rotor motor with built-in thermal protection. A perforated inlet grille acts as an air filter to prevent debris entering and removes the need for an internal filter.

Using air curtains in these types of industrial situations makes internal temperature control more practical, as heat loss through these often wide open doors is significantly reduced.

A standard manual controller, 10 metres of control cable and an IR handheld remote are included. Other control options available include the Clever controller or the BMS interface.

 COLOURS AVAILABLE White RAL9016 (standard) Any RAL colour	 MOUNTING OPTIONS Horizontal Vertical	 MAX DOOR HEIGHT Horizontal 8m Vertical 16m (2x8m)	 FAN OPTIONS AC fan (standard)	 HEATING OPTIONS Electric LPHW Heat pump Air only	 LENGTHS AVAILABLE 1.0m 2.5m 1.5m 3.0m 2.0m
--	---	--	---	---	--



Air only

Model	Max mounting height m	Airflow m³/h	Power/current fans 230V-50Hz kW/A	Noise level (@5m) dB(A)	Weight kg
L 1000 A	5	4000	1.04 / 4.40	63	72
L 1500 A	5	6000	1.56 / 6.60	64	108
L 2000 A	5	8000	2.08 / 8.80	65	145
L 2500 A	5	10000	2.60 / 11	66	177
L 3000 A	5	12000	3.12 / 13.20	67	213
XL 1000 A	8	5300	1.40 / 6	65	78
XL 1500 A	8	7950	2.10 / 9	66	117
XL 2000 A	8	10600	2.80 / 12	67	157
XL 2500 A	8	13250	3.50 / 15	68	192
XL 3000 A	8	15900	4.20 / 18	69	211

Electrically heated

Model	Max mounting height m	Airflow m³/h	Electrical heating capacity 400Vx3-50Hz kW	Power/current fans 230V-50Hz kW/A	Noise level (@5m) dB(A)	Weight kg
L 1000 E	5	4000	10/15/25	1.04 / 4.40	63	90
L 1500 E	5	6000	15/22.5/37.5	1.56 / 6.60	64	135
L 2000 E	5	8000	20/30/50	2.08 / 8.80	65	180
L 2500 E	5	10000	24/36/60	2.60 / 11	66	225
L 3000 E	5	12000	24/36/60	3.12 / 13.20	67	270
XL 1000 E	8	5300	10/15//25	1.40 / 6	65	95
XL 1000 E37	8	5300	15/22.5/37.5	1.40 / 6	65	96
XL 1500 E	8	7950	15/22.5/37.5	2.10 / 9	66	144
XL 1500 E50	8	7950	20/30/50	2.10 / 9	66	150
XL 2000 E	8	10600	20/30/50	2.80 / 12	67	192
XL 2000 E60	8	10600	24/36/60	2.80 / 12	67	200
XL 2500 E	8	13250	24/36/60	3.50 / 15	68	240
XL 2500 E74	8	13250	27.8/46.4/74.2	3.50 / 15	68	250
XL 3000 E	8	15900	24/36/60	4.20 / 18	69	288
XL 3000 E93	8	15900	34.8/58.2/93	4.20 / 18	69	300

Water heated

Model	Max mounting height m	Airflow m³/h	P86		P64		*P54		Power/current fans 230V-50Hz kW/A	Noise level (@5m) dB(A)	Weight kg
			Water heating capacity 80/60°C kW	Water drop pressure 80/60°C Pa	Water heating capacity 60/40°C kW	Water drop pressure 60/40°C Pa	Water heating capacity 50/40°C kW	Water drop pressure 50/40°C Pa			
L 1000 P	5	3800	19.68	1730	16.18	2570	-	-	1.04 / 4.40	62	89
L 1500 P	5	5700	29.64	950	25.92	3210	-	-	1.56 / 6.60	63	128
L 2000 P	5	7600	43.01	2390	35.58	3680	-	-	2.08 / 8.80	64	171
L 2500 P	5	9500	56.01	4670	45.55	4750	-	-	2.60 / 11	65	214
L 3000 P	5	11400	69.27	8090	56.78	8350	-	-	3.12 / 13.20	66	260
XL 1000 P	8	4900	22.68	2250	18.98	3410	-	-	1.40 / 6	64	94
XL 1500 P	8	7350	34.52	1240	30.45	4270	-	-	2.10 / 9	65	137
XL 2000 P	8	9800	50.10	3140	41.83	4910	-	-	2.80 / 12	66	183
XL 2500 P	8	12250	65.29	6130	53.56	6330	-	-	3.50 / 15	67	227
XL 3000 P	8	14700	80.79	10640	66.78	11140	-	-	4.20 / 18	68	278

Water heated: P86 2 row coil, P64 3 row coil, 1000, 1500 units 2 x 1" connections, 2000, 2500 units 2 x 1¼" connections, 3000 units 2 x 1½" connections.

* Available to special order.

Layouts and dimensions

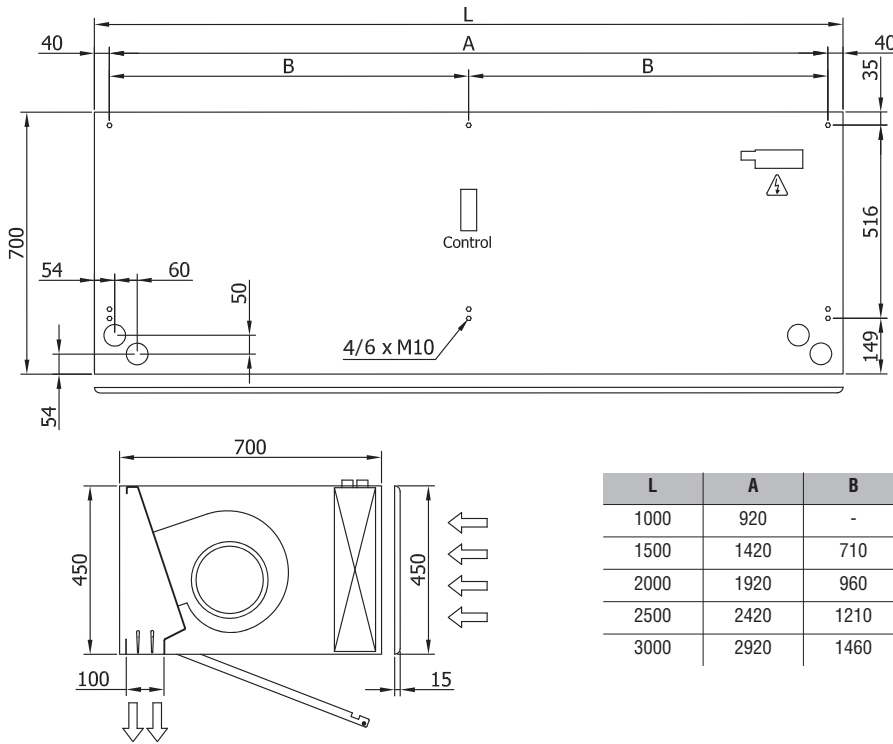

Grille finishes

