



Options available

The Windbox offers a functional design with many features, from energy saving controls to special finishes.

Low noise centrifugal double inlet fans are driven by an external motor rotor with a built in thermal protection contact. The perforated inlet grilles have filter functions that are easy to maintain. A low turbulence discharge nozzle with a double blow-out vane is aerofoil shaped and can be adjustable from 0 to 15° on either side.

The Windbox is suitable for medium to large sized premises and, as they can be mounted end-to-end, they can accommodate very wide entrances such as shopping centres, airports or sports arenas.

A standard manual controller, 7 metres of control cable and an IR handheld remote are included. Other control options available include the Clever controller or the BMS interface.

COLOURS AVAILABLE White RAL9016 (standard) Any RAL colour	MOUNTING OPTIONS Horizontal	MAX DOOR HEIGHT 4.2m	FAN OPTIONS AC fan (standard) EC fan (option)	HEATING OPTIONS Electric LPHW Heat pump Air only	LENGTHS AVAILABLE 1.0m 2.5m 1.5m 3.0m 2.0m
--	---------------------------------------	--------------------------------	--	---	--

Air only

Model	Max mounting height m	Airflow m³/h	Power/current fans 230V-50Hz kW/A	Noise level (@5m) dB(A)	Weight kg
M 1000	3.5	1800	0.212 / 0.94	55	31
M 1500 A	3.5	2700	0.318 / 1.41	56	46
M 2000 A	3.5	3600	0.424 / 1.88	57	58
M 2500 A	3.5	4500	0.530 / 2.35	58	72
M 3000 A	3.5	5400	0.636 / 2.82	59	86
ECM 1000 A	3.5	1840	0.150 / 1.30	56	31
ECM 1500 A	3.5	2760	0.225 / 1.95	57	46
ECM 2000 A	3.5	3680	0.300 / 2.60	58	58
ECM 2500 A	3.5	4600	0.375 / 3.25	59	72
ECM 3000 A	3.5	5520	0.450 / 3.90	60	86
G 1000 A	3.8	2400	0.642 / 2.85	57	43
G 1500 A	3.8	3200	0.856 / 3.80	58	51
G 2000 A	3.8	4800	1.284 / 5.70	59	80
G 2500 A	3.8	5600	1.498 / 6.65	60	84
G 3000 A	3.8	6400	1.712 / 7.60	61	95
ECG 1000 A	4.2	2700	0.225 / 1.95	61	43
ECG 1500 A	4.2	3600	0.300 / 2.60	62	51
ECG 2000 A	4.2	5400	0.450 / 3.90	63	80
ECG 2500 A	4.2	6300	0.525 / 4.55	64	84
ECG 3000 A	4.2	7200	0.600 / 5.20	65	95

Electrically heated

Model	Max mounting height m	Airflow m³/h	Electrical heating capacity 400Vx3-50Hz kW	Power/current fans 230V-50Hz kW/A	Noise level (@5m) dB(A)	Weight kg
M 1000 E	3.5	1800	3/6/9	0.212 / 0.94	55	37
M 1500 E	3.5	2700	4/8/12	0.318 / 1.41	56	57
M 2000 E	3.5	3600	6/12/18	0.424 / 1.88	57	75
M 2500 E	3.5	4500	6/12/18	0.530 / 2.35	58	94
M 3000 E	3.5	5400	8/16/24	0.636 / 2.82	59	112
ECM 1000 E	3.5	1840	3/6/9	0.150 / 1.30	56	37
ECM 1500 E	3.5	2760	4/8/12	0.225 / 1.95	57	57
ECM 2000 E	3.5	3680	6/12/18	0.300 / 2.60	58	75
ECM 2500 E	3.5	4600	6/12/18	0.375 / 3.25	59	94
ECM 3000 E	3.5	5520	8/16/24	0.450 / 3.90	60	112
G 1000 E	3.8	2400	5/10/15	0.642 / 2.85	57	52
G 1500 E	3.8	3200	7.5/15/22.5	0.856 / 3.80	58	63
G 2000 E	3.8	4800	10/20/30	1.284 / 5.70	59	100
G 2500 E	3.8	5600	10/20/30	1.498 / 6.65	60	106
G 3000 E	3.8	6400	10/20/30	1.712 / 7.60	61	120
ECG 1000 E	4.2	2700	5/10/15	0.225 / 1.95	61	52
ECG 1500 E	4.2	3600	7.5/15/22.5	0.300 / 2.60	62	63
ECG 2000 E	4.2	5400	10/20/30	0.450 / 3.90	63	100
ECG 2500 E	4.2	6300	10/20/30	0.525 / 4.55	64	106
ECG 3000 E	4.2	7200	10/20/30	0.600 / 5.20	65	120

Water heated

Model	Max mounting height m	Airflow m³/h	P86		P64		P54		Power/current fans 230V-50Hz kW/A	Noise level (@5m) dB(A)	Weight kg
			Water heating capacity 80/60°C kW	Water drop pressure 80/60°C Pa	Water heating capacity 60/40°C kW	Water drop pressure 60/40°C Pa	Water heating capacity 50/40°C kW	Water drop pressure 50/40°C Pa			
M 1000 P	3.5	1660	9.17	880	8.56	4370	8.52	1220	0.428 / 1.90	56	35
M 1500 P	3.5	2490	14.26	760	13.69	6460	14.34	4480	0.642 / 2.85	57	53
M 2000 P	3.5	3320	20.65	1930	18.26	4790	18.65	2060	0.856 / 3.80	58	69
M 2500 P	3.5	4150	26.92	3810	22.12	3850	24.32	4040	1.070 / 4.75	59	86
M 3000 P	3.5	4980	33.24	6590	28.37	6760	29.77	5660	1.280 / 5.70	60	103
ECM 1000 P	3.5	1720	9.38	920	8.77	4560	8.74	1280	0.150 / 1.30	56	35
ECM 1500 P	3.5	2580	14.58	790	14.02	6730	14.71	4690	0.225 / 1.95	57	53
ECM 2000 P	3.5	3440	21.12	2010	18.70	4990	19.13	2150	0.300 / 2.60	58	69
ECM 2500 P	3.5	4300	27.53	3960	23.33	4010	24.95	4230	0.375 / 3.25	59	86
ECM 3000 P	3.5	5160	40.00	6860	29.05	7050	30.54	5920	0.450 / 3.90	60	103
G 1000 P	3.8	2250	11.04	1230	10.42	6190	10.56	1790	0.642 / 2.85	57	50
G 1500 P	3.8	3000	16.02	940	15.47	8020	16.37	5670	0.856 / 3.80	58	59
G 2000 P	3.8	4500	24.92	2700	22.29	6810	23.15	3030	1.284 / 5.70	59	92
G 2500 P	3.8	5250	31.16	4930	26.61	5060	28.76	5450	1.498 / 6.65	60	96
G 3000 P	3.8	6000	37.35	8110	32.10	8410	34.03	7180	1.712 / 7.60	61	109
ECG 1000 P	4.2	2550	11.89	1400	11.27	7110	11.50	2090	0.225 / 1.95	61	50
ECG 1500 P	4.2	3400	17.29	1070	16.77	9240	17.86	6620	0.300 / 2.60	62	59
ECG 2000 P	4.2	5100	26.86	3080	24.14	7850	25.24	3530	0.450 / 3.90	63	92
ECG 2500 P	4.2	5950	33.63	5650	28.84	5840	31.38	6360	0.525 / 4.55	64	96
ECG 3000 P	4.2	6800	40.34	9290	34.81	9710	37.16	8400	0.600 / 5.20	65	109

P86 - 2 rows coil, 2 x ¼" female connector. P64 - 3 rows coil, 2 x ¼" female connector. P54 - 4 rows coil, 2 x 1" male connector.

Layouts and dimensions

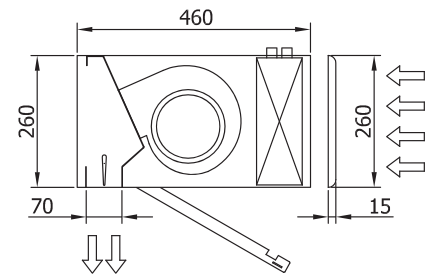
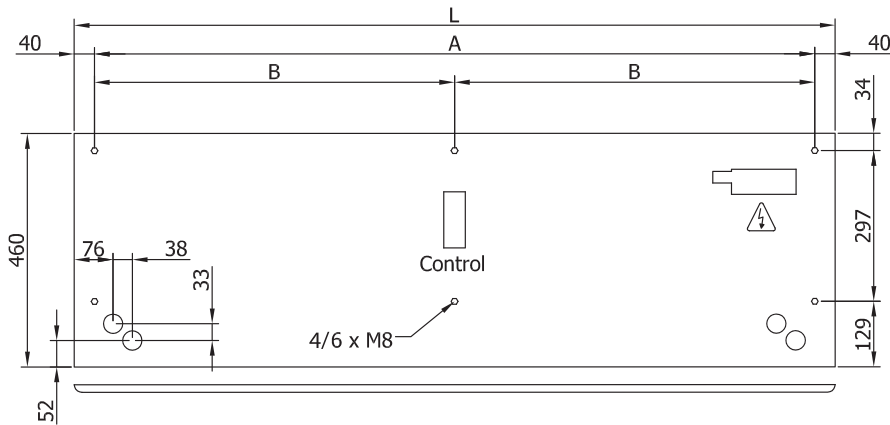

L	A	B
1000	920	-
1500	1420	710
2000	1920	960
2500	2420	1210
3000	2920	1460